



宏茂五金

HOMER

HARDWARE INC.

BUCKLE / EXTENSION / BELT RETRACTOR / AUTO PART
HOOK PART / LOCK STRIKER / LATCH / HINGE



NOTE

目錄

CONTENTS

● ABOUT US	01	● HOOK PART 安全勾	26
● EQUIPMENTS	03	Hook	26
● BUCKLE 安全扣	05	Eye Swivel	26
Push Bottom Buckles 按壓釋放	05	Shackle	29
Flip Release Buckles 掀蓋釋放	15	Tie Down Part	29
Side Release Buckles 側邊釋放	18	Trailer Tie Loop	29
● PRODUCTS EXTENSION 應用延伸	19	● CAR LOCK STRIKER 車鎖	30
● SEAT BELT RETRACTOR 兩點式/捲尺座	21	● LATCH 扣件	32
● AUTO PART 配件	23	● HINGE 鉸鍊	35



公司簡介 ABOUT US

宏茂五金專精於汽車零件、家具五金、客製化產品等製造已深耕逾30年。秉持著「品質嚴控」、「誠信經營」、「持續創新」的企業理念，並備有符合國際標準各種檢驗及測試儀器，以確保為客戶提供高品質的產品和服務。

從開發到生產、包裝、出貨，我們一貫化的作業流程，嚴格的品檢制度，控管產品品質，提高效率，以達到客戶要求。

隨著二代的引領，在這個不斷進步的公司環境中，我們勇於探索新的可能性，將原有的產品注入創新的靈感，拓展到未曾想像過的領域。未來，宏茂五金將以自動化機械設備為核心，降低人力成本，以提高客戶產業競爭力為目標邁進。

Celebrating a rich history spanning thirty years, Homer Hardware Inc. stands out as a distinguished leader in automotive and furniture hardware, offering bespoke solutions to meet diverse needs. Our foundation is built on the pillars of 'stringent quality control,' 'business integrity,' and 'continuous innovation'. Unwavering in our pursuit of excellence, we ensure the delivery of unparalleled products and services to our valued clients.

Explore our diverse product catalog organized into three main categories: Automotive spare parts, including seat belts, car locks, hinges, and versatile metal components; Furniture hardware, featuring hinges, handles, latches, and a range of metal/non-metal components; and Customized hardware tailored to meet unique specifications.

Rooted in stamping manufacturing, our expertise spans various processes: plastic injection molding, casting, lathe milling, rubber injection, and aluminum extrusion. Our variety of inspection equipment, including 3D printers, tensile testers, salt spray chambers, and fatigue testing machines, ensures high standards from development to production, packaging, and shipping. Our unwavering commitment to consistent operational procedures, rigorous quality inspections, and product control enhances efficiency, seamlessly meeting and exceeding customer demands.

Under second-generation leadership, Homer Hardware embarks on a journey of exploration in a dynamic business landscape. Injecting innovative ideas into our existing products, we boldly venture into uncharted territories. Our vision for the future revolves around smart automation, promising a more convenient ordering experience for our valued clients.

Choose Homer Hardware Inc. for an unparalleled blend of tradition, innovation, and reliability in every solution we provide.

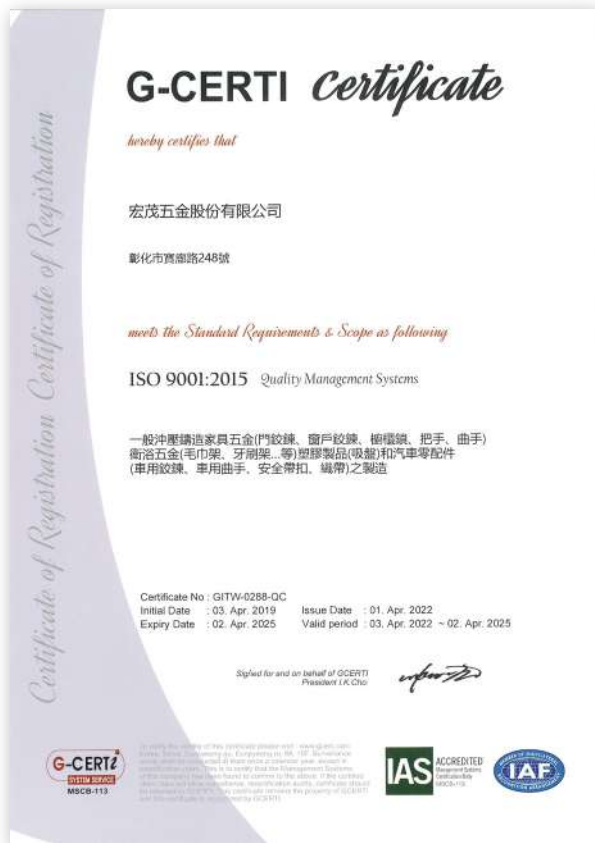

榮獲ISO 9001 : 2015 CERTIFACATION 優質生產力 · 創造企業競爭力



持續改善
 IMPROVEMENT



誠信經營
 INTEGRITY



不斷創新
 INNOVATION





雷射雕刻機

LASER
ENGRAVER

雷射切割機

LASER CUTTING
MACHINE

織帶機

SEWING
MACHINE

鉚合機

RIVETING
MACHINE

鑄造設備

DIE CASTING
MACHINE

大型沖床機台

BIG STAMPING
MACHINE

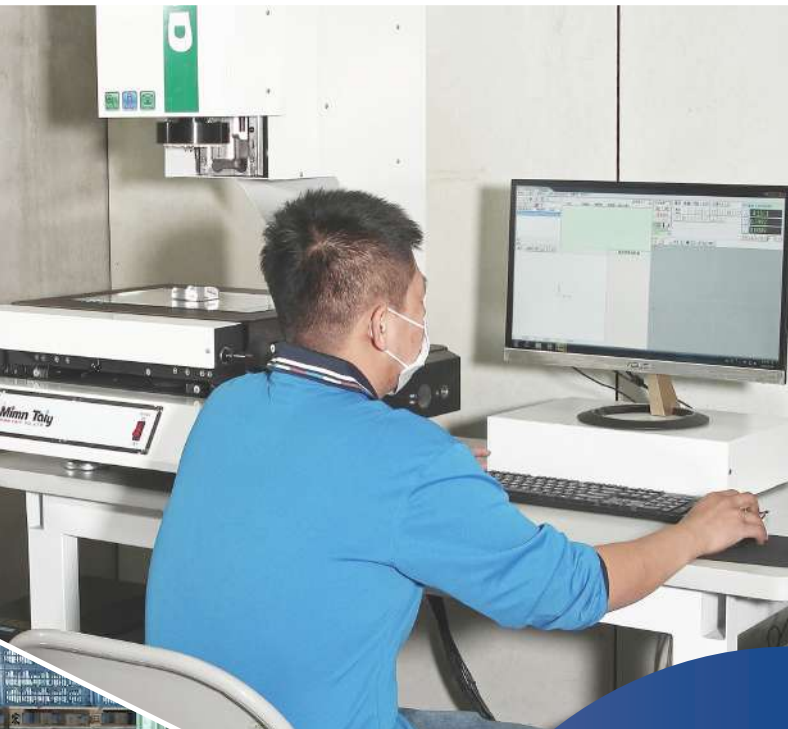

2.5D投影機
2.5D
PROJECTOR



鹽霧測試機
SALT SPRAY
TESTER



品檢包裝
QUALITY CONTROL
& PACKING



拉力測試機
TENSILE
TESTER



檢測客製化
INSPECTION
CUSTOMIZED

硬度測試機
HARDNESS
TESTER



BUCKLE

CA-01

BUCKLE

EXTENSION

BELT RETRACTOR

AUTO PART

HOOK PART

LOCK STRIKER

LATCH

HINGE



CA-0100E

Webbing hole
23.5mm

Size
64.5mm×48.2mm

防誤壓



CA-0120E

Webbing hole
23.5mm

Size
64.5mm×48.2mm

Function
Prevent accidental presses

防誤壓



CA-0150E

Webbing hole
23.5mm

Size
64.5mm×48.2mm

Function
Prevent accidental presses

2孔



CA-0110E

Webbing hole
23.5mm

Size
64.5mm×48.2mm

Function
Two hole



CW-1001A

STEEL+ABS

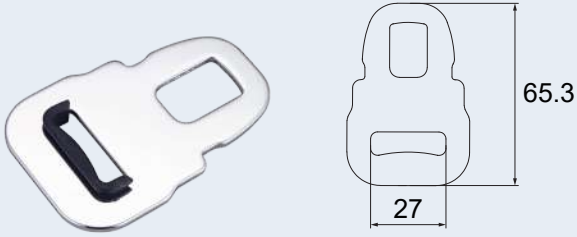

CW-1005

STEEL+ABS

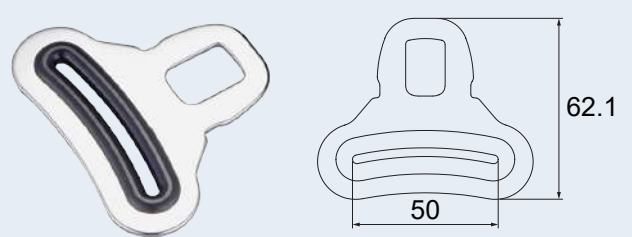

CW-1111

STEEL+ABS

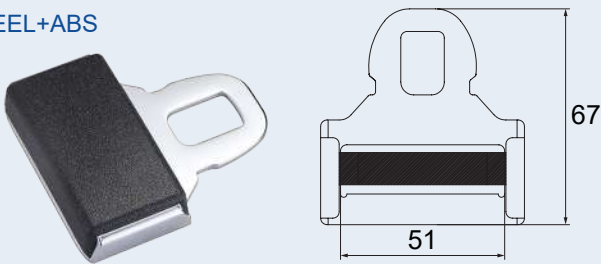

CW-1121

STEEL+ABS

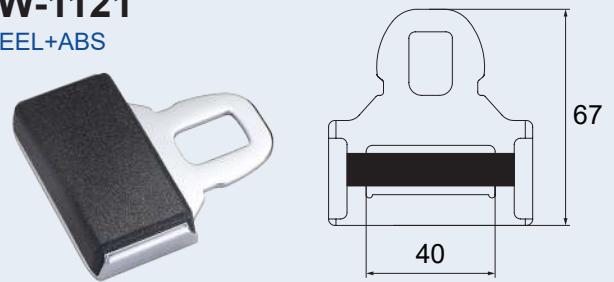

CW-1211

STEEL+ABS

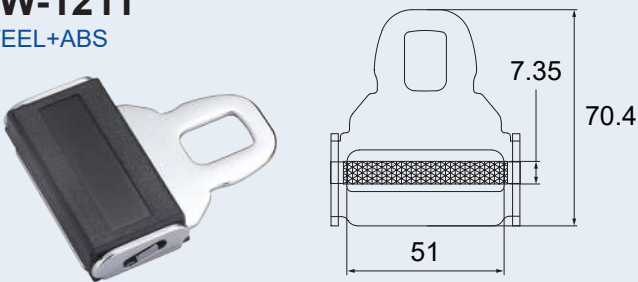

CW-1212

STEEL+ABS

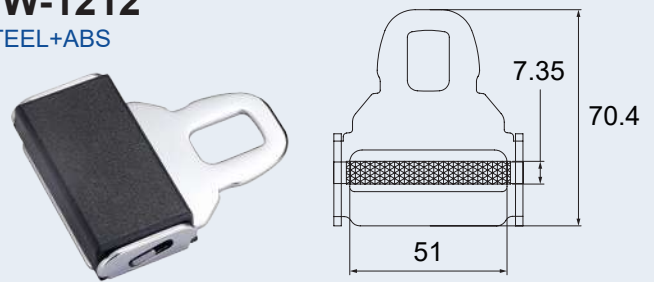

CW-1231

STEEL+ABS

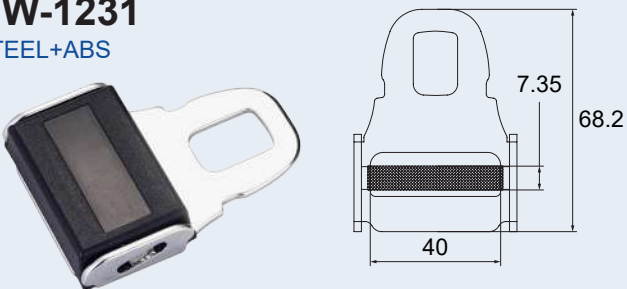

CW-1232

STEEL+ABS

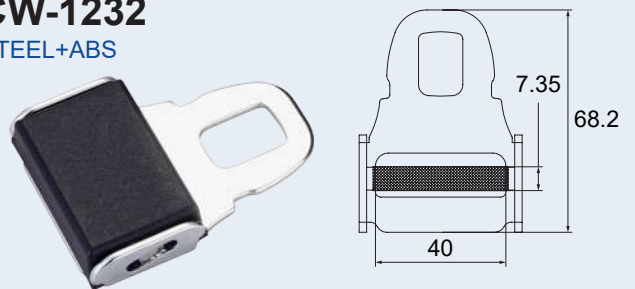



CA-0200E

Webbing hole
Ø26.9mm

Size
170mm×51mm



CA-0211E

Webbing hole
Ø13mm

Size
365mm×51mm



CA-0221E

Webbing hole
Ø15.5mm

Size
180mm×51mm



CA-0230E

Webbing hole
Ø13mm

Size
170mm×51mm



CA-0231EA

Webbing hole
Ø13mm

Size
170mm×51mm



CA-0240E

Webbing hole
Ø12mm

Size
170mm×51mm



CA-0251E

Webbing hole
Ø12mm

Size
170mm×51mm

延伸且消音



CA-0260E

Webbing hole
36mm×21.6mm

Size
170mm×51mm

Function
Extended fasteners and silence



CA-0270E

Webbing hole
Ø12mm

Size
170mm×51mm

CW-2001

Steel+ABS

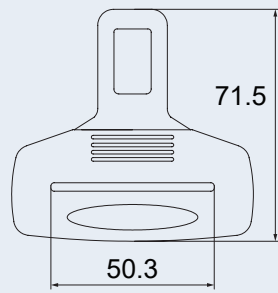

CW-2002

Steel

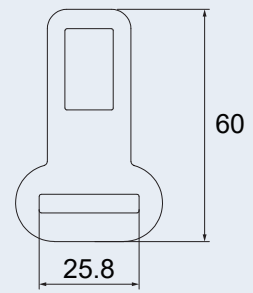

CW-2122

STEEL+ABS

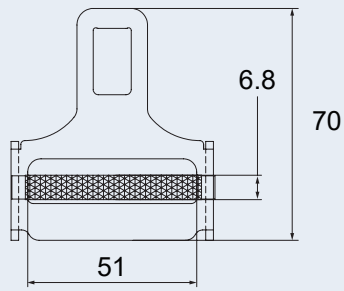

CA-03

CB-03

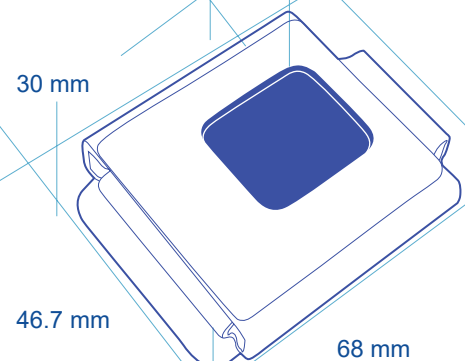
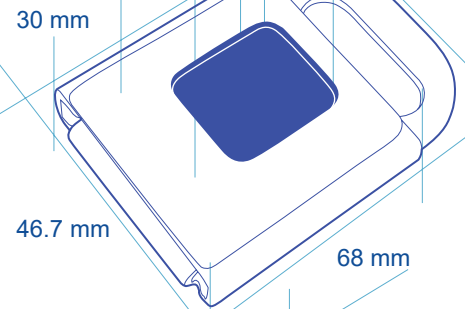
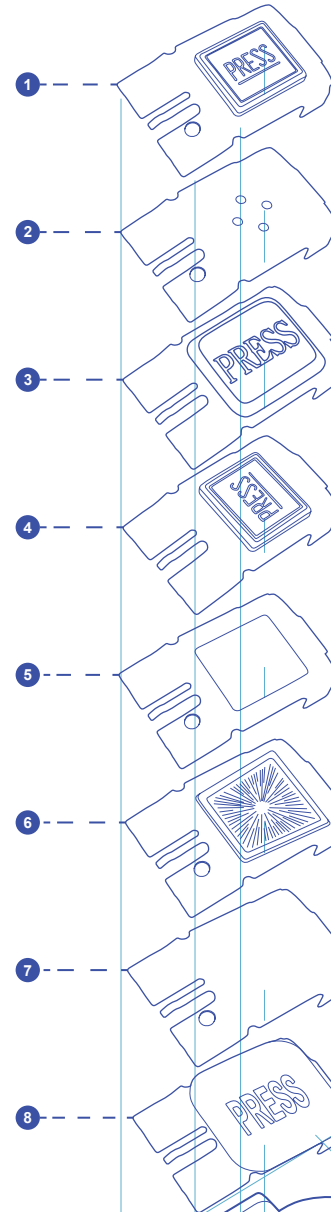

CA-05



1



2



3



4



5

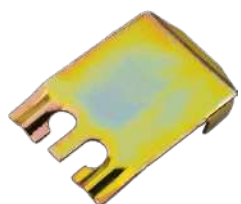

1



2

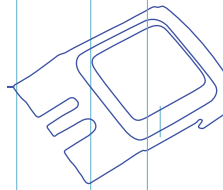

3

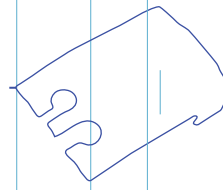

4

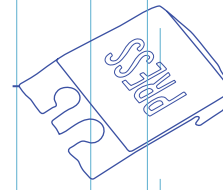

5

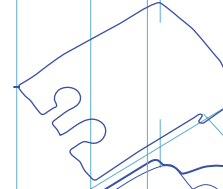

23.8 mm

30 mm

40.7 mm

SIZES COMPARISON

CA-03

Regular



CB-05

M



CA-05

S





CA-0300A

Webbing hole
30mm

Size
68mm×46.7mm



CA-0301C

Webbing hole
30mm

Size
68mm×46.7mm



CA-0303A

Webbing hole
30mm

Size
68mm×46.7mm



CA-0306A

Webbing hole
30mm

Size
68mm×46.7mm

防誤壓



CA-0310A

Webbing hole
30mm

Size
68mm×46.7mm

Function
Prevent accidental presses



CA-0356A

Webbing hole
30mm

Size
68mm×46.7mm



CA-0360BP

Webbing hole
25mm

Size
68mm×46.7mm



CA-0380B

Webbing hole
25mm

Size
68mm×46.7mm



CA-03951A

Webbing hole
30mm

Size
68mm×46.7mm



CA-0303TCA

Webbing hole
50mm

Size
75mm×46.7mm

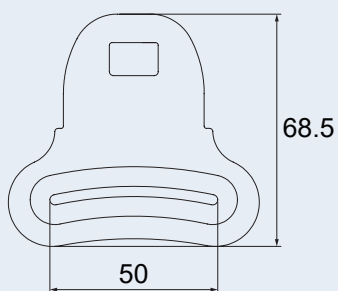
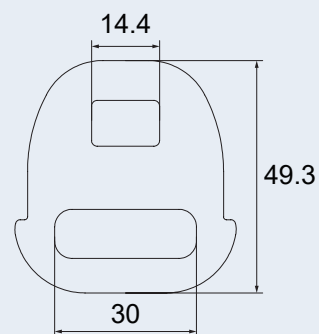
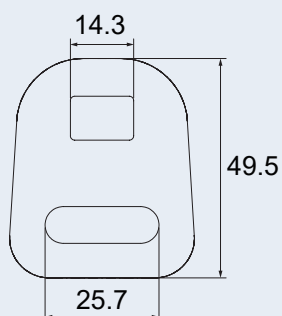
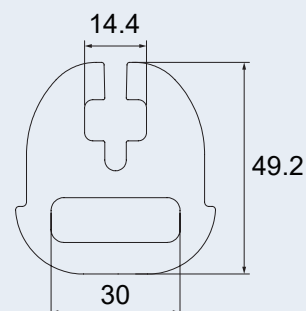
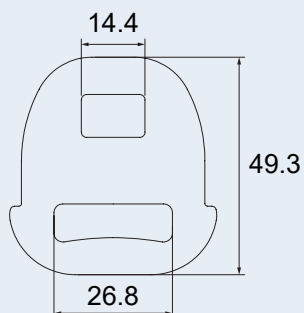
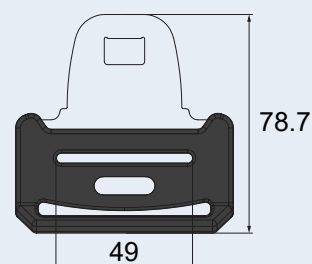
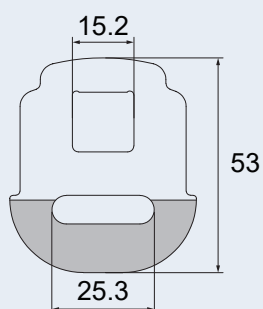
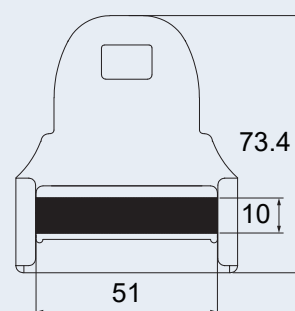
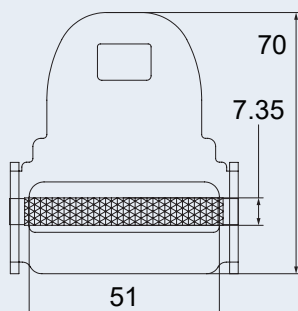
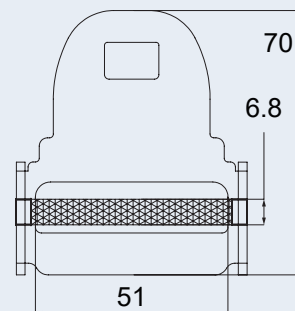
CW-3001
STEEL+ABS**CW-3002**
STEEL**CW-3003**
STEEL**CW-3004**
STEEL**CW-3005A**
STEEL+ABS**CW-3007**
STEEL+ABS**CW-3008**
STEEL+PU**CW-3111**
STEEL+ABS**CW-3211**
STEEL+ABS**CW-3222**
STEEL+ABS

BUCKLE

CA-05
CB-05

BUCKLE

EXTENSION

BELT RETRACTOR

AUTO PART

HOOK PART

LOCK STRIKER

LATCH

HINGE

CB-0501A



Webbing hole
25mm

Size
55mm×38mm

CB-0501A1



Webbing hole
25mm

Size
55mm×38mm

CB-0500B



Webbing hole
25mm

Size
55mm×38mm

CX-5002

STEEL

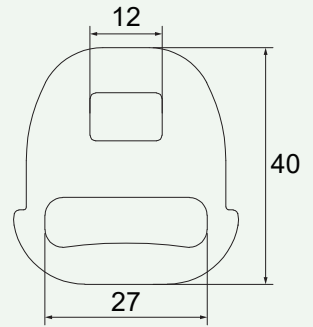

CA-0500A



Webbing hole
23.8mm

Size
40.7mm×30mm

CA-0502



Webbing hole
23.8mm

Size
40.7mm×30mm

CA-0503C



Webbing hole
23.8mm

Size
40.7mm×30mm

防誤壓



CA-0510A

Webbing hole
23.8mm

Size
40.7mm×30mm

Function
Prevent accidental presses

CW-5002

STEEL

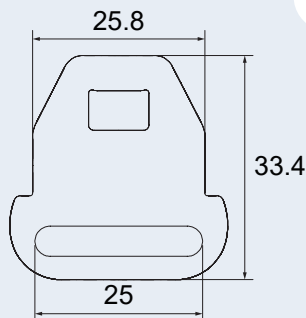

CW-5111

STEEL+ABS

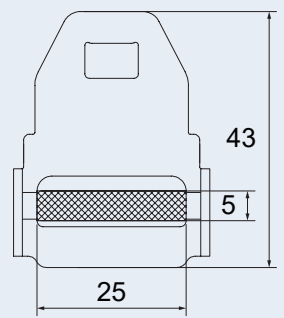

SIZES COMPARISON

CA-04 Regular



CB-04 M



CB-02 S



CB-01 XS

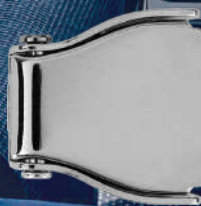

BUCKLE

CA-04
CB-04

脫離角度可調整



CA-0410G1

Webbing hole
50.4mm

Size
65mm×58mm

Function
Releasing angle

CW-4001

STEEL

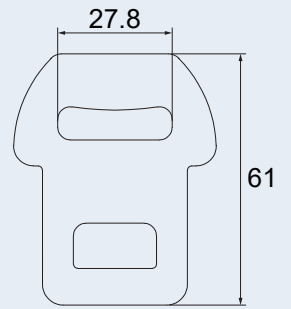

CW-4002

STEEL+ABS

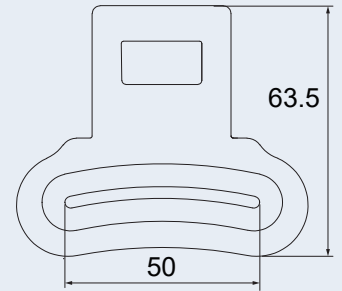

CA-0410GA3

Webbing hole
50.4mm

Size
65mm×58mm

Function
Releasing angle



CA-0410GA4

Webbing hole
50.4mm

Size
65mm×58mm

Function
Releasing angle



CW-4511

STEEL+ABS

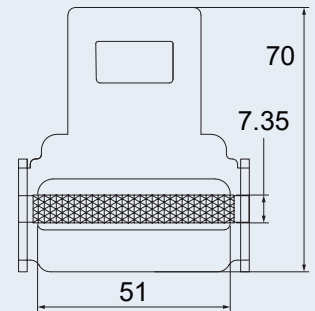

CW-4512

STEEL+ABS

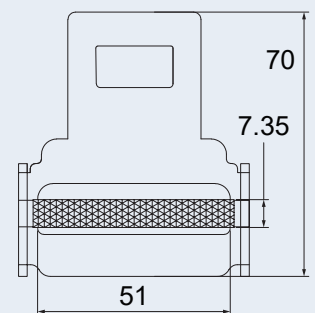

BUCKLE RELEASE ANGLE

CA-0410G3
CA-0410G4



45 Degree



90 Degree

BUCKLE

CB-02
CB-04

BUCKLE

EXTENSION

BELT RETRACTOR

AUTO PART

HOOK PART

LOCK STRIKER

LATCH

HINGE



CB-0410A

Webbing hole
42.5mm

Size
49.5mm×55.5mm



CX-4010A

STEEL

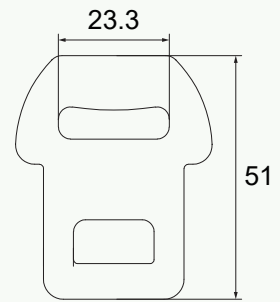

CB-0210A

Webbing hole
24.8mm

Size
28.9mm×32.4mm



CX-2010A

STEEL

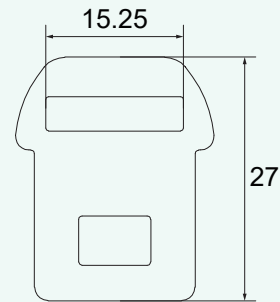

CB-0110A

Webbing hole
19mm

Size
26.1mm×26mm



CX-1110A

STEEL

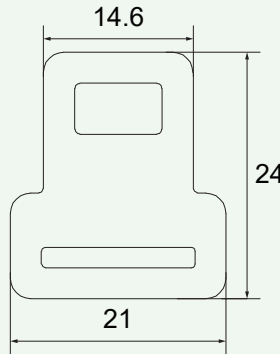

CA-1410A2

Webbing hole
52mm

Size
60mm×54mm



CW-4003

STEEL

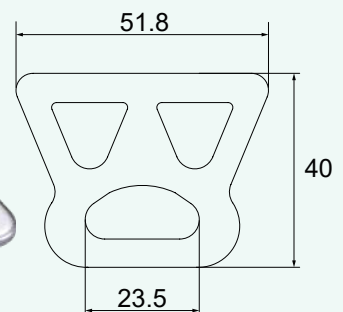

BUCKLE

CA-06

BUCKLE

EXTENSION

BELT RETRACTOR

AUTO PART

HOOK PART

LOCK STRIKER

LATCH

HINGE



CA-0600A

Webbing hole
52mm

Size
62.3mm×60mm



CA-0600B

Webbing hole
52mm

Size
62.3mm×60mm

2孔



CA-0620A

Webbing hole
52mm

Size
62.3mm×60mm

Function
Two hole



CW-6001

STEEL

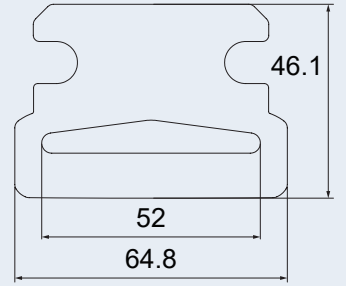

CW-6111

STEEL+ABS

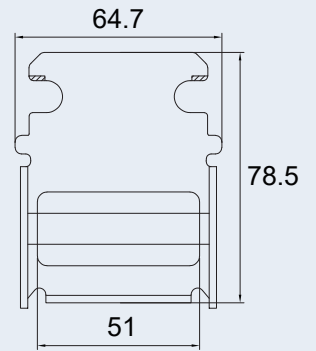

CW-6221

STEEL+ABS

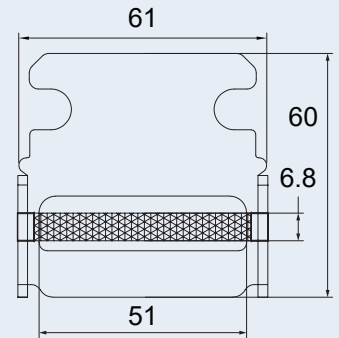

CW-6222

STEEL+ABS

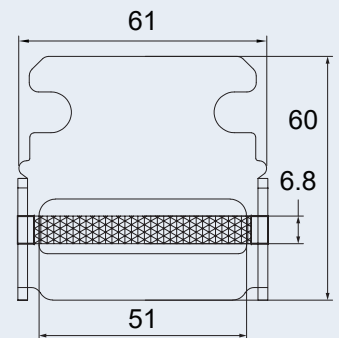

CA-0600A Regular



CA-0900A L



COMPARISON

BUCKLE

CA-07

CA-08

BUCKLE

EXTENSION

BELT RETRACTOR

AUTO PART

HOOK PART

LOCK STRIKER

LATCH

HINGE



CA-0700A

Webbing hole
46mm

Size
60mm×54.5mm

CW-7001

STEEL

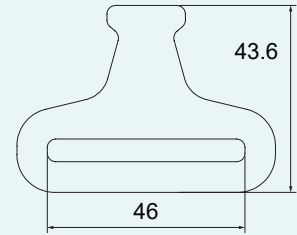

CW-7002

STEEL

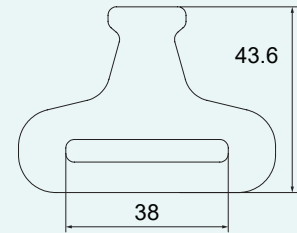

CA-0800A

Webbing hole
20mm

Size
36mm×40mm

CW-8001C

STEEL

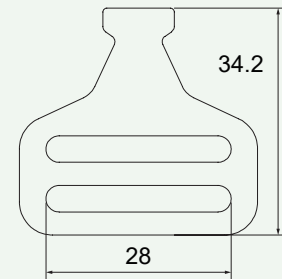

CA0810C

Webbing hole
26mm

Size
36mm×40mm

CA-8002C

STEEL

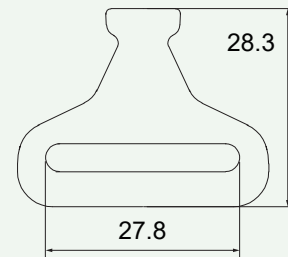

COMPARISON

CA-0700A Regular



CA-0810C S



**PRODUCTS
EXTENSION**

應用延伸

BUCKLE

EXTENSION

C0001E



HO-FED035



BELT RETRACTOR

HO-TER2349



CA-1502A

Waist buckle



AUTO PART

ID Badge-301



Keychain-201



HOOK PART

Keychain-301



Keychain-501



LOCK STRIKER

LATCH

Keychain-502



Keychain-801



HINGE

Tool Bag-01



Tool Bag-02



Tool Bag-03



Tool Bag-04



BUCKLE

EXTENSION

BELT RETRACTOR

AUTO PART

HOOK PART

LOCK STRIKER

LATCH

HINGE

SEAT BELT RETRACTOR

BUCKLE

CD-0306A-A01

24.4"+47"



CD-0410G1-A01

24.4"+47"



EXTENSION

BELT RETRACTOR

CD-0600A-A01

24.4"+47"



CD-0700A-A01

24.4"+47"



AUTO PART

CQ-200A-B01

24.4"+47"



CQ-201A-C01

24.4"+47"



HOOK PART

C0100E-Q501E-15

24.4"+47"



C0100E-Q601E-20

24.4"+47"



LOCK STRIKER

LATCH

CR-501E-2001

24.4"+47"



HO-FEC-028A

60"



HINGE

HO-FEC056

48.5"+4.7"



HO-FES016

47"



HO-FEC017

35"+11"



HO-FEB029

11.8"



HO-FEB005K3

120"



HO-FEC041

40"+6.5"



HO-FEB003C

118"



HO-FEB028

118"



HO-FEB016

120"



HO-FEP041

40"+6.5"



BUCKLE

EXTENSION

BELT RETRACTOR

AUTO PART

HOOK PART

LOCK STRIKER

LATCH

HINGE

BUCKLE

EXTENSION

BELT RETRACTOR

AUTO PART

HOOK PART

LOCK STRIKER

LATCH

HINGE

CY-003A

T : 2.8mm
STEEL

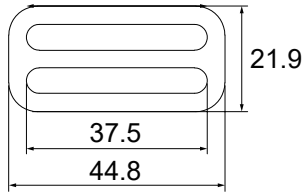

CY-004A

T : 3.2mm
STEEL

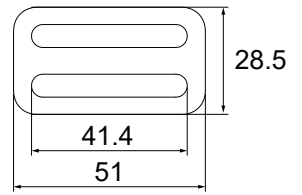

CY-005A

T : 3.5mm
STEEL

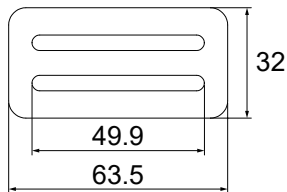

CY-006A

T : 1.8mm
STEEL

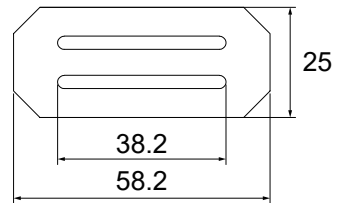
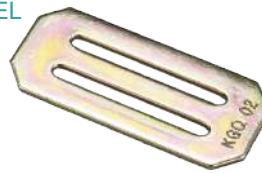

CY-007A

T : 2.5mm
STEEL

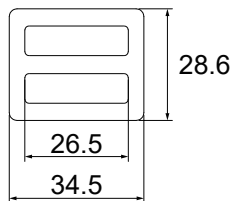

CY-008BA

Hole : 12.7mm&15.7mm
T : 4mm
STEEL

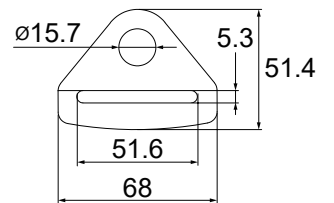

CY-011B

T : 4mm
STEEL

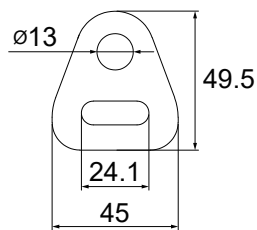

CY-015ABA

T : 3mm
STEEL

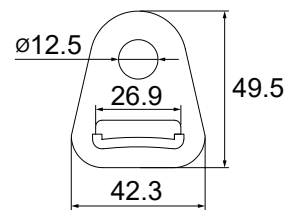

CY-016A

STEEL+PA6

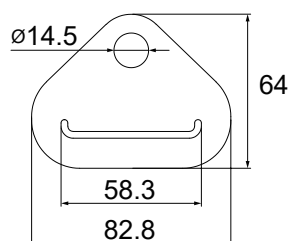

CY-017A

T : 3mm
STEEL

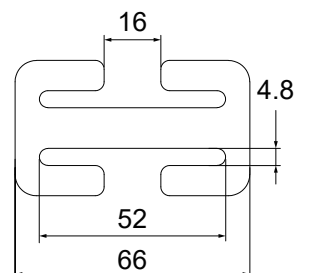

CY-022A

T : 5mm
STEEL

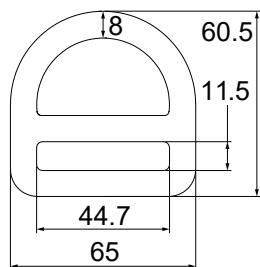

CY-039A

T : 5mm
STEEL

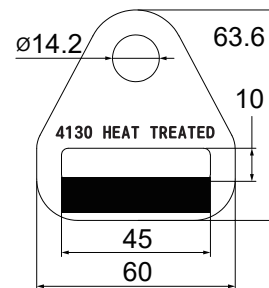

CY-041A

T : 4.4mm
Zinc Alloy

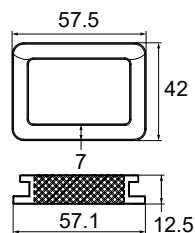

CY-044AA

T : 2.5mm
STEEL+ABS

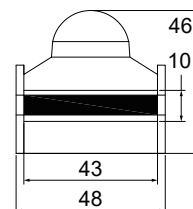

CY-045A

T : 2.3mm
STEEL+ABS

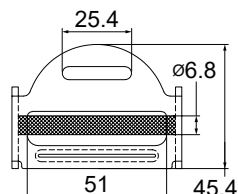

CY-046A

T : 3mm
ALUMINUM

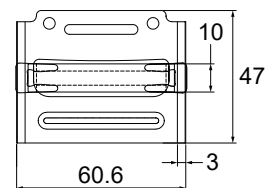

CY-048AA

T : 3mm
STEEL+ABS

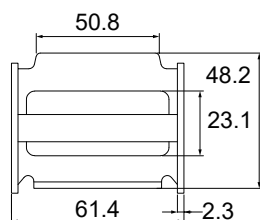
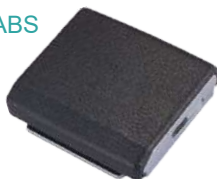

CY-049A

T : 4.5mm
PE

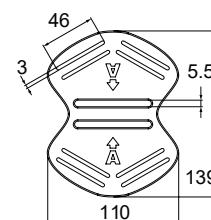

CY-050A 粗

T : 2.3mm
STEEL

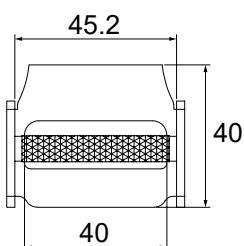

CY-054B

T : 2.2mm
PE

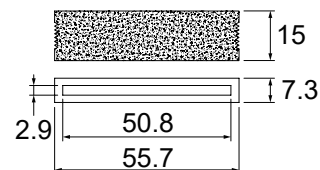
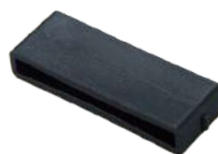

BUCKLE

EXTENSION

BELT RETRACTOR

AUTO PART

HOOK PART

LOCK STRIKER

LATCH

HINGE

BUCKLE

EXTENSION

BELT RETRACTOR

AUTO PART

HOOK PART

LOCK STRIKER

LATCH

HINGE

CY-901AC

Hole : 16.3mm&15.2mm
STEEL+ABS

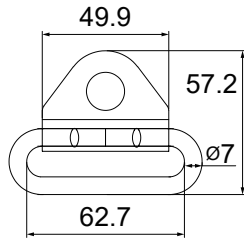

CY-901AB

Hole : 14.25mm
STEEL

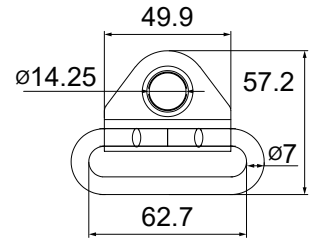

J243B

STEEL

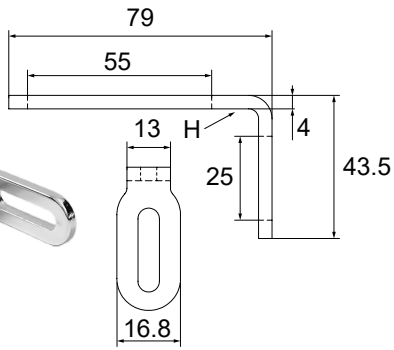

HOOK

安全钩

TC-010AA

T : 4.2mm
STEEL

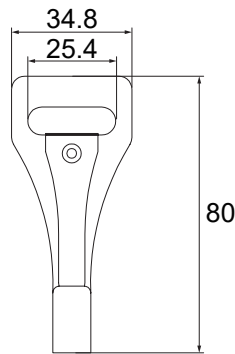

TC-020AA

T : 2.35mm
STEEL

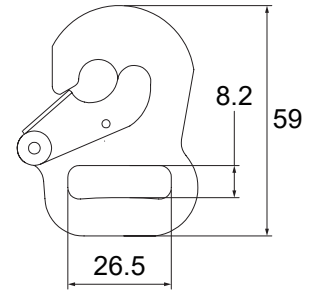

TC-030AA

T : 4mm
STEEL

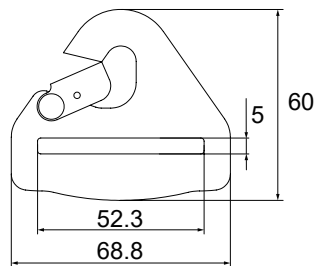

TC-050

T : 4.2mm
STEEL

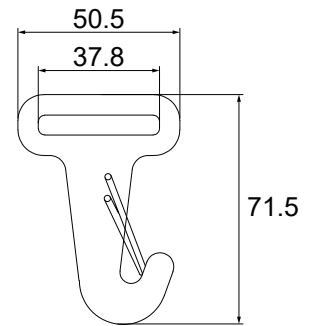

HO-TB-005

88mm*48mm
STEEL

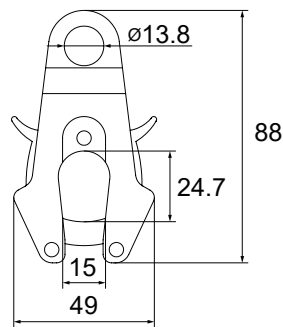

HO-TB-006

ø11mm
STEEL

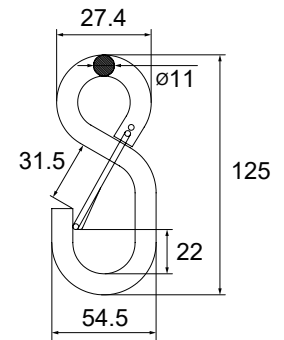

HO-TB-007

ø8.8mm
STEEL

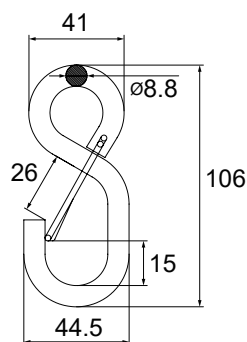

HO-TB-008

ø9.5mm
STEEL

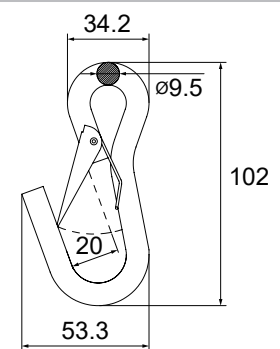

HO-S2511

146.5mm*65.1mm
SS304

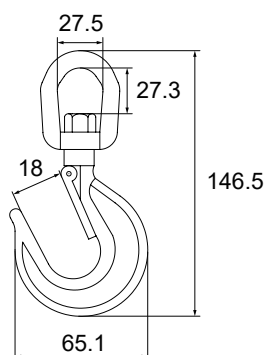

HO-S2311

99.5mm*48.2mm
SS304

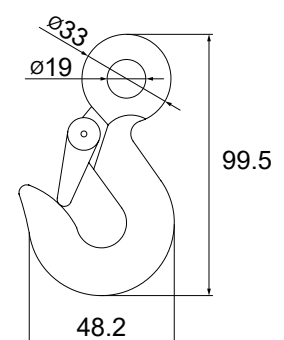

BUCKLE

EXTENSION

BELT RETRACTOR

AUTO PART

HOOK PART

LOCK STRIKER

LATCH

HINGE

HOOK

安全钩

BUCKLE

EXTENSION

BELT RETRACTOR

AUTO PART

HOOK PART

LOCK STRIKER

LATCH

HINGE

HO-S325X

L : 88.5mm
SS316

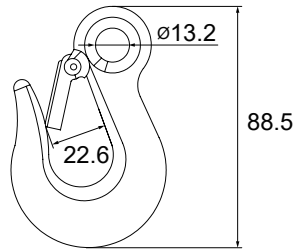

HO-S3387

80mm*29.6mm
SS304

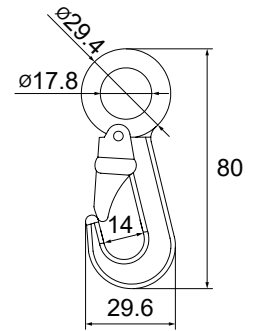

HO-S247H

74.1mm*30.4mm
SS304

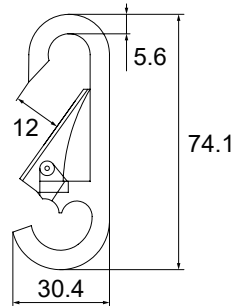

HO-S247A

79mm*26mm
SS304

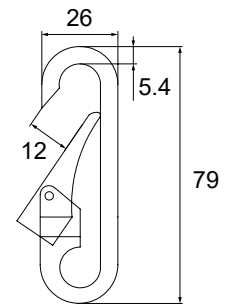

HO-S2470

49.5mm*25mm
SS304

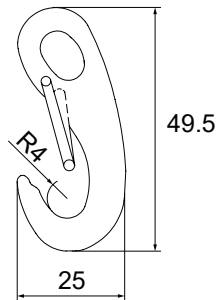

HO-S24505X

7.8mm
SS316

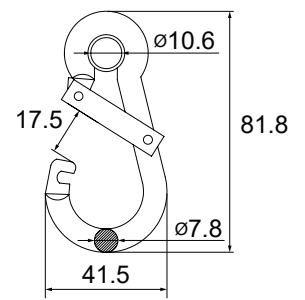

HO-TB004

8mm
SS304

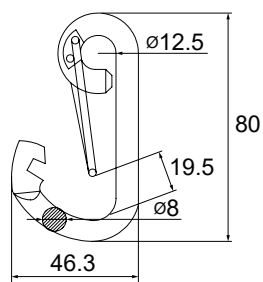

HO-S2430

6mm
SS304

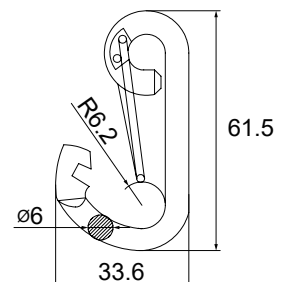

HO-S24502NX

5.8mm
SS304

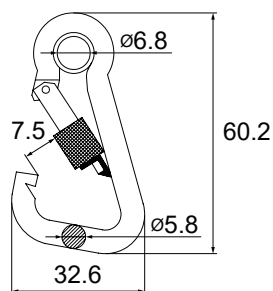

HO-S2450NX

6mm
SS304

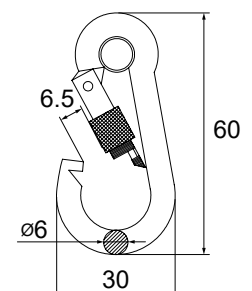

HO-S24501X

ø5.8mm
SS304

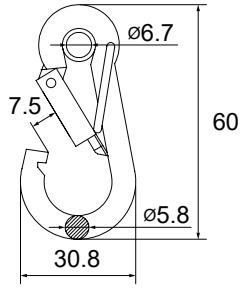

HO-S2450X

ø4.8mm
SS304

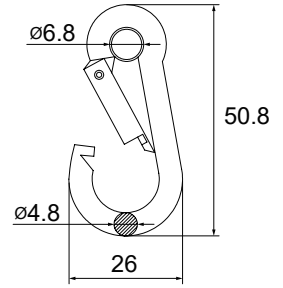

HO-S8751

ø4.8mm
SS316

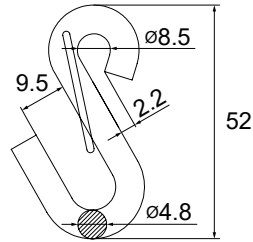

BUCKLE

EXTENSION

BELT RETRACTOR

AUTO PART

HOOK PART

LOCK STRIKER

LATCH

HINGE

HOOK

安全钩

BUCKLE

HO-S0181

ø6mm
SS304

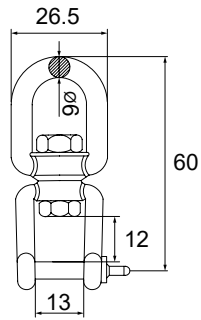

HO-S0180

ø9.3mm
SS316

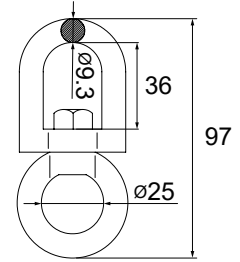

EXTENSION

BELT RETRACTOR

HO-S370F

ø4.7mm
SS304

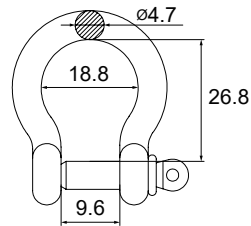

HO-S3193

56mm*45.2mm
SS316

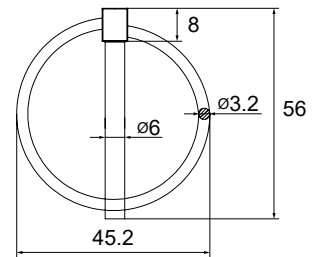

AUTO PART

HO-S3217

ø4.8mm
SS304

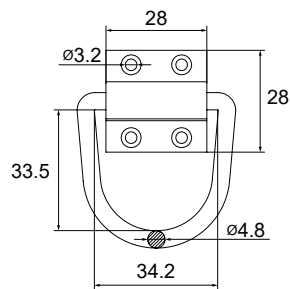

HO-S3218-0003

SS304

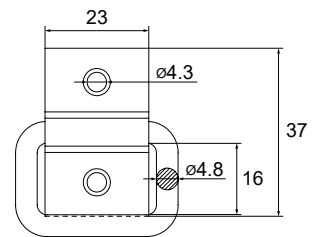

HOOK PART

LOCK STRIKER

HO-S3110

SS304

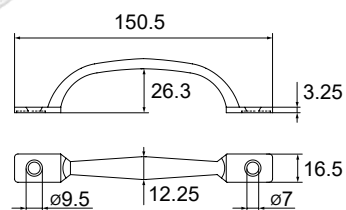

HO-S322H-0050

SS304

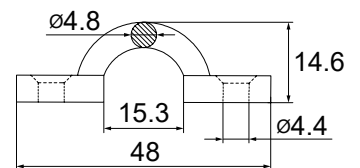

LATCH

HINGE

YB-001A

STEEL

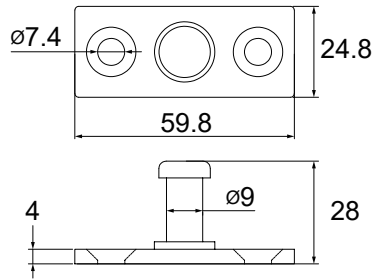

YB-002A

STEEL

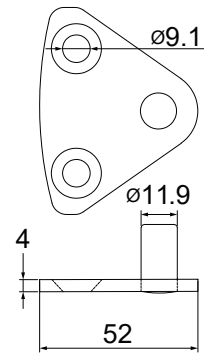

YC-010B

STEEL

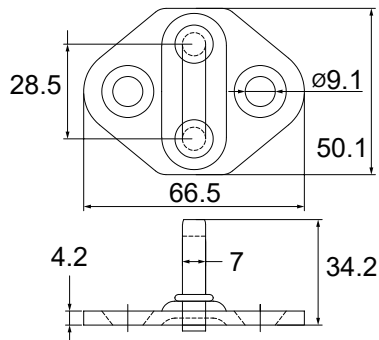

YC-011A 長

STEEL

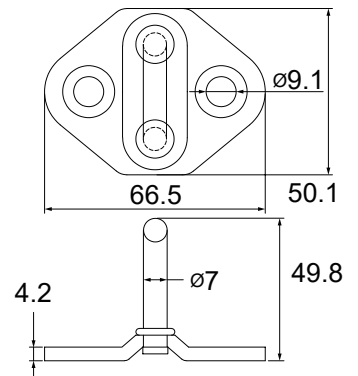

YC-012A

STEEL

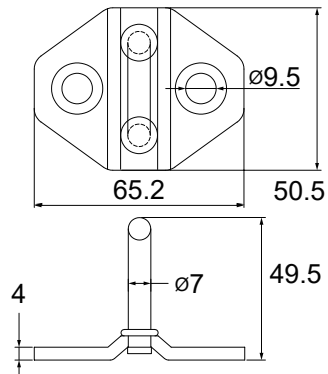

YC-012B

STEEL

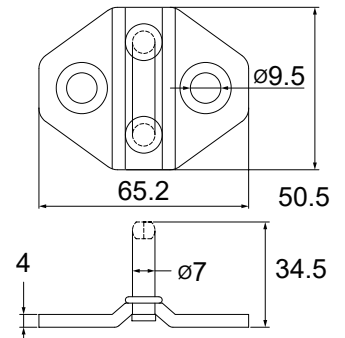

YC-021A

STEEL

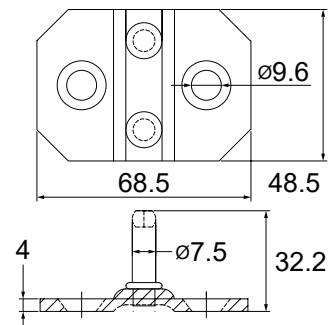

YC-022A

STEEL

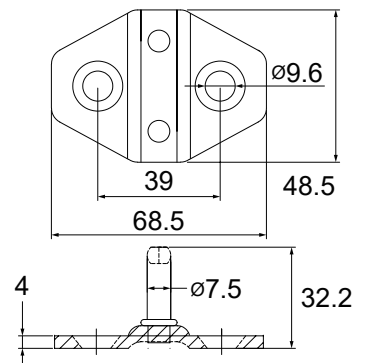

YC-023A

STEEL

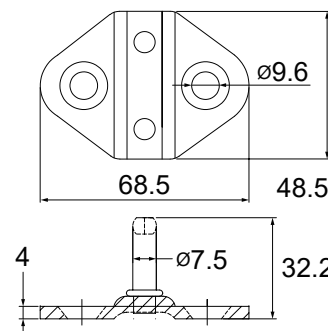

YC-024A

STEEL

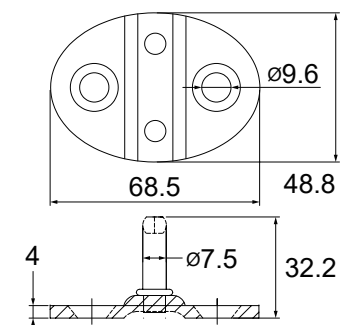

BUCKLE

EXTENSION

BELT RETRACTOR

AUTO PART

HOOK PART

LOCK STRIKER

LATCH

HINGE

LOCK STRIKER

車鎖

BUCKLE

YA-001 L/R

STEEL



YA-002 L/R

STEEL



EXTENSION

BELT RETRACTOR

YA-003 L/R

STEEL



YA-004 L/R

STEEL



AUTO PART

YA-005

STEEL



YA-006

STEEL



HOOK PART

LOCK STRIKER

LATCH

HINGE

LATCH 扣件

TA-001A
STEEL

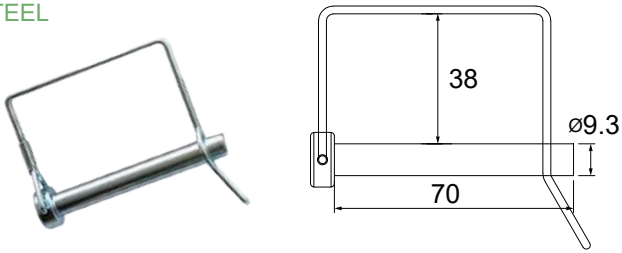

TA-002A
STEEL

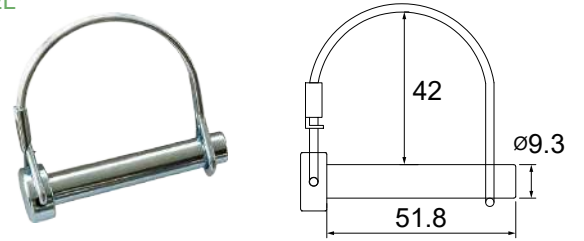

TA-003A
STEEL

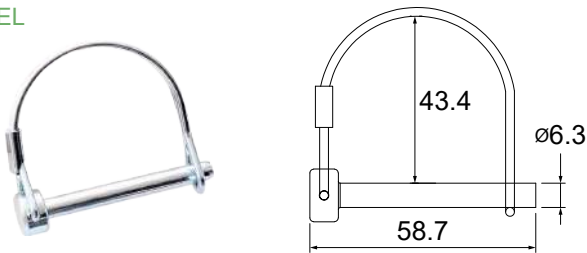

TB-001A
SS304



TB-002A
SS304

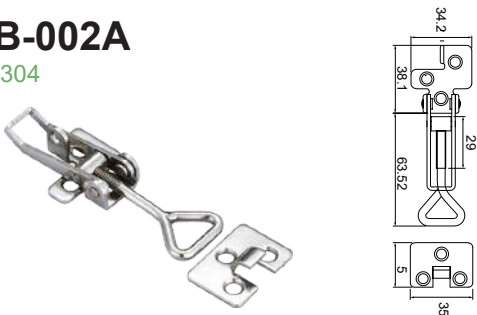

TB-003A
SS304



TB-003B
SS304



TB-004A
STEEL / SS304



TB-004B
STEEL / SS304

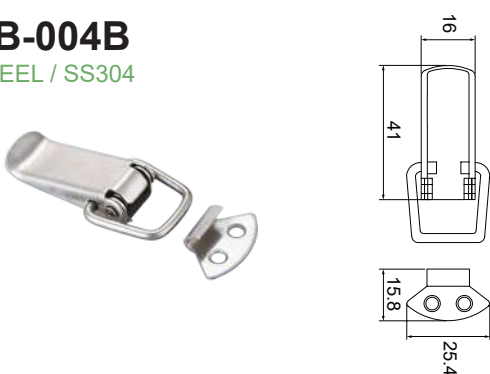

TB-005A
STEEL

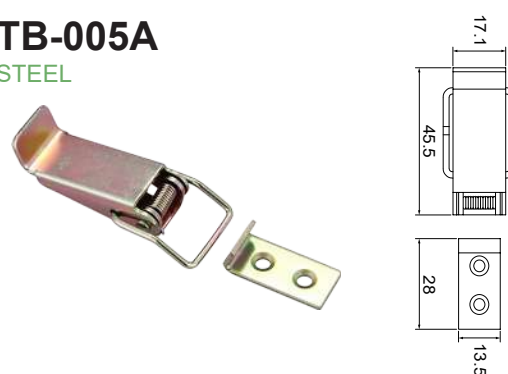

BUCKLE

EXTENSION

BELT RETRACTOR

AUTO PART

HOOK PART

LOCK STRIKER

LATCH

HINGE

LATCH

扣件

BUCKLE

TB-006AA
STEEL / SS304

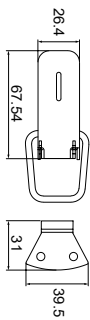

TB-006BA
STEEL / SS304

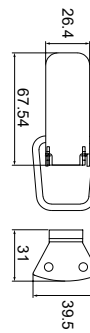

EXTENSION

BELT RETRACTOR

TB-010AA
STEEL

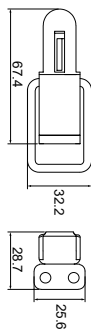

TB-011AB
STEEL / SS304

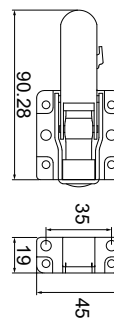

AUTO PART

HOOK PART

TB-015A
STEEL / SS304

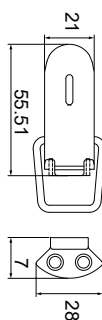

TB-015B
STEEL / SS304

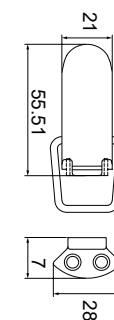

LOCK STRIKER

TB-025A
SS304

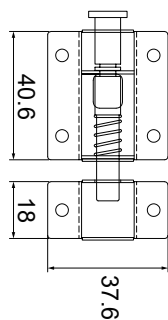

TB-026A
SS304

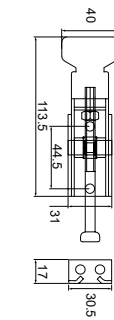

LATCH

HINGE

TB-027A
SS304

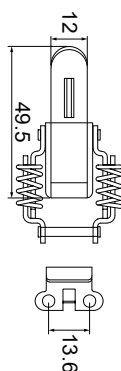

TB-027B
SS304

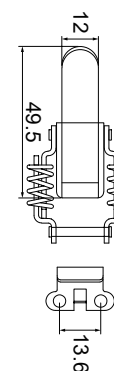

TB-030A

SS304

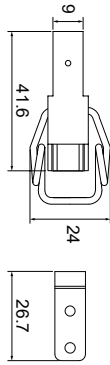

TB-031A

SS304

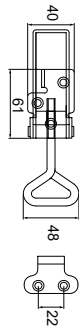

TB-032A

SS304

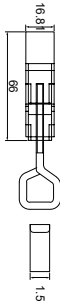

TB-033A

STEEL

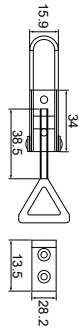

TB-034AA

SS304

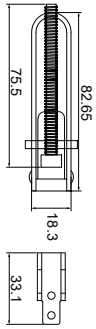

TB-035A

SS304

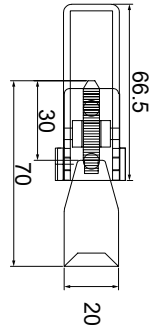

TB-036A

SS304

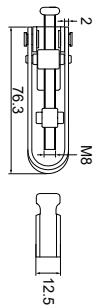

TB-037A

SS304

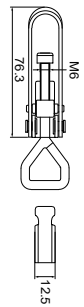

TB-039A

SS304

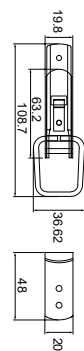

HINGE

鉸鏈

BUCKLE

YD-001

96×102×6.2mm
STEEL



EXTENSION

YE-010L/R

117×187×8mm
STEEL



BELT RETRACTOR

YE-020L/R

75×164×6mm
STEEL



YE-021L/R

75.5×210×6mm
STEEL



AUTO PART

YE-030L/R

67×24×4.2mm
STEEL



YE-031L/R

63×288×6.2mm
STEEL



HOOK PART

YE-032L/R

59.5×188×3.5mm
STEEL



YE-040L/R

74×209×9mm
STEEL



LOCK STRIKER

LATCH

HINGE

NOTE



2024

HOMER
HARDWARE INC.



 +886-4-727-3349

 +886-4-724-6499

 888@homer888.com.tw

 www.homer888.com

 NO 248, BAObU RD.,
CHANGHUA CITY 500049 TAIWAN, R.O.C.
500 彰化市寶廊路 248 號